

SELF-TESTING MAINTAINED EMERGENCY LUMINAIRES WITH LED's



TECHNICAL CHARACTERISTICS	GRL-822	GRL-824	GRL-832	GRL-834	GRL-842	GRL-844
OPERATION VOLTAGE	220-240V AC/50-60Hz					
MAXIMUM POWER CONSUMPTION	8W/12VA	8W/10VA	9W/11VA	10.5W/12.5VA	11.5W/13.5VA	12W/14VA
BATTERIES (Ni-Cd)	3.6V/1.5Ah	4.8V/1.5Ah	4.8V/1.5Ah	4.8V/3Ah	4.8V/1.5Ah	4.8V/3Ah
BATTERY PROTECTION	From overcharge and full discharge					
INDICATIONS - CONTROLS	Charge LED, Lamp fault LED, Fault LED, TEST button					
CHARGING TIME	24 h					
MINIMUM AUTONOMOUS DURATION	90 min	3 h	90 min	3 h	90 min	3 h
ILLUMINATION SOURCE	White LED's					
LIGHT SOURCE INTENSITY (230V AC/emerg.)	420lm / 210lm		560lm / 280lm		700lm / 350lm	
DEGREES OF COVER PROTECTION	IP 42					
PRODUCED IN ACCORDANCE WITH	EN 60598-1, EN 60598-2-22, EN 55015, EN 61547, EN 61000-3-2, EN 61000-3-3, EN 1838					
OPERATION TEMPERATURE RANGE	0 to 40 °C					
RELATIVE HUMIDITY	Up to 95%					
CONSTRUCTION MATERIALS	Aluminum, Bayblend FR3010, transparent polycarbonate					
EXTERNAL DIMENSIONS	390 x 260 x 50 mm		480 x 320 x 50 mm		635 x 400 x 50 mm	
TYPICAL WEIGHT	1190gr.	1290gr.	1660gr.	1760gr.	2310gr.	2410gr.
GUARANTEE	3 years (1 year for the battery)					

Thank you for purchasing this product of Olympia Electronics. A European manufacturer.

GENERAL

These luminaires are used in places where emergency luminaires are needed.

Each luminaire must be permanently connected to mains power supply.

In normal operation the led strip lights and the battery is charging.

In case of a mains power supply failure the luminaire will light the led strip automatically in emergency mode. When the mains power supply is restored the device turns to normal operation.

INSTALLATION

To install the luminaire follow the installation instructions on page 2.

Battery Cut-off

The luminaire enters in this operation when the mains power supply fails and battery has lost its energy. During this operation the luminaire enters the idle state and battery consumption is negligible, in order to be protected from deep discharge.

Battery charging

The battery charging is completely controled. In this case, is achieved the perfect battery maintenance , as well as the elongation of its duration. When the battery has completely charged, it charges with a maintenance current.

Manual Test

The manual test can be conducted only if the main power supply and the battery is connected. By pressing the test button briefly an operation test is initiated. During this test period all indication LEDs are OFF.

Automatic test

This test includes all the operations that provide the manual test and is conducted automatically every 15 days. In order to be performed, the main power supply and the battery should be connected.

Automatic Autonomous Test

The Automatic autonomous Test is conducted and measures the luminaire's back up operation.

This test is conducted automatically every six months. In order to be performed, the main power supply and the battery should be connected (the battery should be charged). If the battery is not charged, the test is postponed until the battery is completely charged. If during the Automatic Autonomous Test the luminaire's duration is lower than the named, then the battery must be replaced.

Back Up Operation

The autonomous duration of battery during emergency mode is at least the one that is stated in the list of the first page. During emergency mode, a LED strip test is also performed.

Resetting Errors

Push the Test button for 5 seconds, to extinguish all the indicated LED errors. Then the luminaire enters regular operation mode.

Indication LED status (with connected mains power supply).

AC Charge

On: Good charge current.

Off: No battery (No charging current or disconnected battery).

Lamp fault

On: faulty LED strip.

Off: Good LED strip.

Fault

Off: Battery OK.

Blink (With AC Charge LED ON): Autonomy or low battery problem

(the battery must be replaced).

Blink (With AC Charge LED Off):

No charging current or disconnected battery.

ATTENTION!!!

1. Operations for installation, maintenance or testing must be done by authorized personnel only.

2. The device must be connected to the mains power supply thru a fuse dependent by the total amount of the line's power load.

3. In case of battery or lamp replacement, these must be replaced by parts of the same type, by the manufacturer or by a competent person.

4. In case of inactive use for a period greater than 2 months, disconnect the battery by pulling out the battery's connector.

5. It is not allowed to discard batteries in to common trash bins, they must be discarded only in battery recycling points. Do not incinerate.

NOTE: LED= Light Emitting Diode

LABELING EXPLANATION:

X: Self contained

1: Maintained

A: Including test device

***90: 90min duration**

180: 180min duration

INSTALLATION INSTRUCTIONS

- ① Remove the metal side cover by unscrewing the two retaining screws.
- ② Remove the acrylic plates by sliding them out.
- ③ Connect the battery's cable as shown in the picture.
- ④ Mount the luminaire using the supplied accessories and electrically connect it to the mains (figures 1,2). Yellow wire to GND, blue to N, brown to L and black to L1 for maintained operation. The L1 wire can be connected to an external switch to control the maintained or non-maintained operation of the luminaire. For permanent maintained operation use three wires to power the luminaire, GND for ground N for neutral, L for live wire, and link the L and L1.
- ⑤ Refit the acrylic plates and the side cover by screwing the removed screws in step 1.
- ⑥ Power on the device.

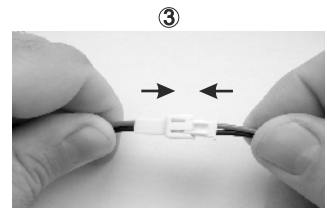
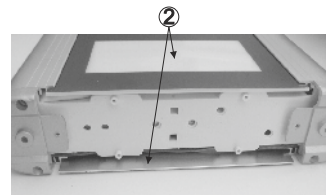
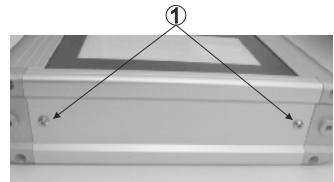
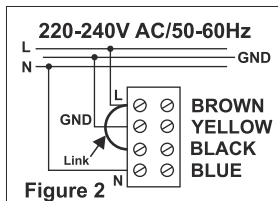
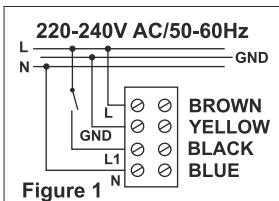

MOUNTING METHODS

FLAG MOUNTED ON A WALL



1. Pass thru the cable from the plastic supporting base's hole.

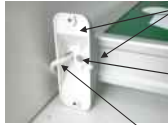

2. Place the plastic supporting base so it can fit on the edge of the mounting screw.
3. Fasten the mounting screw. Also place the second plastic supporting base in the bottom side of the luminaire.

4. During installation pass the cable from the cut out of the plastic supporting base, and connect the wires to the included terminal blocks.

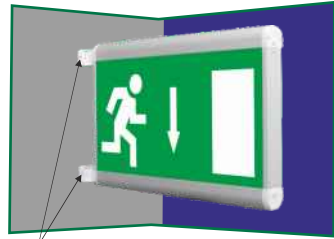

Mounting holes.

5. Mount the luminaire with the included mounting accessories (screws and mounting plugs).

SURFACE MOUNTING ON A WALL (single side luminaire)



1. Place the plastic supporting base.
2. Fasten the mounting screw. Also place the second plastic supporting base in the opposite side of the luminaire.

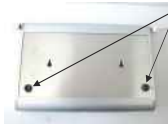

3. Place on the rear side of the luminaire the included self-adhesive rubber pads.
4. Mount the luminaire with the included mounting accessories (screws and mounting plugs).



Mounting point.

CEILING MOUNTED



1. Measure the distance between the two supporting bases, to be mounted in the ceiling. Install them with the screws and mounting plugs. Place the luminaire, so it can fit on these plastic bases.



2. Fasten the mounting screw. Do the same to the other base in the opposite side of the luminaire.

ALTERNATIVE CEILING MOUNTED



1. Pass the cable thru the pipe (with external threading) of the plastic supporting base.

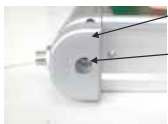

2. Place the plastic supporting base.
3. Fasten the mounting screw. Also place the second plastic supporting base in the opposite side of the luminaire.



4. Pass the cable thru the tube (with internal thread).



5. Place the tube (with internal thread) and carefully turn it clockwise to mount it properly. Do the same to the other supporting base.

Metallic mounting eyelet (after request).
Expansion chain (after request).

Supporting link.

