

## " DOUBLE LIGHT " SERIES FOR MAINTAINED LUMINAIRES



TECHNICAL CHARACTERISTICS	GR-515/15L	GR-516/15L
OPERATION VOLTAGE	220-240V AC/50-60Hz	
MAXIMUM POWER CONSUMPTION	3.5W / 7VA	
BATTERIES (Ni-Cd)	3.6V/1Ah	3.6V/1.5Ah
BATTERY PROTECTION	From overcharge and deep discharge	
INDICATIONS - CONTROLS	Battery charging LED, TEST button	
CHARGING TIME	24h	
MINIMUM AUTONOMOUS DURATION	90 min	3 h
ILLUMINATION SOURCE	15 white LED's	
ILLUMINATION (MAINS / EMERGENCY)	105lm / 105lm	
DEGREES OF COVER PROTECTION	IP 20	
PRODUCED IN ACCORDANCE WITH	EN 60598-1, EN 60598-2-22, EN 55015, EN 61547, EN 61000-3-2, EN 61000-3-3	
OPERATION TEMPERATURE RANGE	0 to 40 °C	
RELATIVE HUMIDITY	Up to 95%	
CONSTRUCTION MATERIALS	Bayblend FR3010, transparent polycarbonate	
EXTERNAL DIMENSIONS	332 x 100 x 205 mm	
TYPICAL WEIGHT	850gr	920gr
GUARANTEE	3 years (1 year for the battery)	

Thank you for purchasing this product of Olympia Electronics. A European manufacturer.

### GENERAL

These luminaires are used indoors (ta 40°C) where emergency light is needed.

Each luminaire must be permanently connected to mains power supply.

In normal operation the led strip lights and the battery is charging.

In case of a mains power supply failure the luminaire will light the led strip automatically in emergency mode (powered by its battery). When the mains power supply is restored the device turns to normal operation.

### INSTALLATION

To install the luminaire follow the installation instructions on page 2.

### ATTENTION!!!

1. Operations for installation, maintainance or testing must be done by authorized personel only.

2. The device must be connected to the mains power supply thru a fuse dependent by the total amount of the line's power load.

3. It is sugested to check every month the indication LED for battery charging, and by pushing the TEST button to check the emergency circuit. The illumination source should light as long as the TEST button is pressed. In the opposite condition contact the installer.

4. It is sugested to check every 6 months the minimum autonomous duration by disconnecting the mains power supply. Count the time that the led strip lights and in case of less time than the minimum autonomous duration the battery must be replaced. If the measured time is considerably less than the minimum autonomous duration contact the installer. In case of battery or led strip replacement, these must be replaced by parts of the same type, by the manufacturer or by a competent person.

5. In case of inactive use for a period greater than 2 months, disconnect the battery by pulling out the battery's connector.

6. **It is not allowed to discard batteries in to common trash bins, they must be discarded only in battery recycling points.**  
 **Do not incinerate.**

## INSTALLATION INSTRUCTIONS

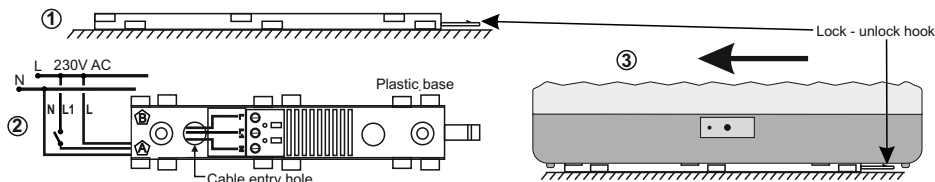

1. Detach the plastic base (located in the bottom of the luminaire) by pulling the unlock hook and pass the cables from area ① or ② and thru the cable entry hole. The luminaire must be connected to a permanent electrical installation to ensure the immobilization of the cable. Mount the plastic base with the included mounting accessories.
2. Connect the mains cables to the respective detachable terminal block. **N for neutral, L for live wire and L1 for the maintained operation.** The L1 wire can be connected to an external switch to control the maintained or non maintained operation of the luminaire. For permanent maintained operation use two wires to power the luminaire, N for neutral and L for live wire, and link the L and L1.
3. Attach the luminaire by sliding it on the plastic base until the plastic hook locks, and power the luminaire.

### NOTE!!

**After finishing the installation you must power the device at least for 24 hours for battery charging to perform the named autonomy.**

**NOTE:** LED= Light Emitting Diode

### LABELING EXPLANATION:

**X:** Self contained

**1:** Maintained (\*)

**A:** Including test device

**\*90:** 1.5 hour duration

**180:** 3 hour duration

(\*) Maintained operation: The luminaire lights its illumination source, when it is powered by the mains power supply or not.

Non-Maintained operation: The luminaire lights its illumination source, only in power supply's failure.

### Battery replacement.

*It can be done only by a competent person and after the mains interruption.*

1. Detach the luminaire from its base (step 1 of the installation procedure).
2. Unfasten the screws and remove the diffuser.
3. Unfasten the screws and remove the reflector.
4. Disconnect the connector and remove the old battery.
5. Connect the new battery with the same type and place it in the position of the old one.
6. Replace the removed parts (step 1,2 and 3).

